

General Notes

- ① Indicative typical detail; please refer to system manufacturer for specific variations
- ② Typical inverted build-up to a Balcony or Terrace shown [NOT for use elsewhere; such as roofs etc.]

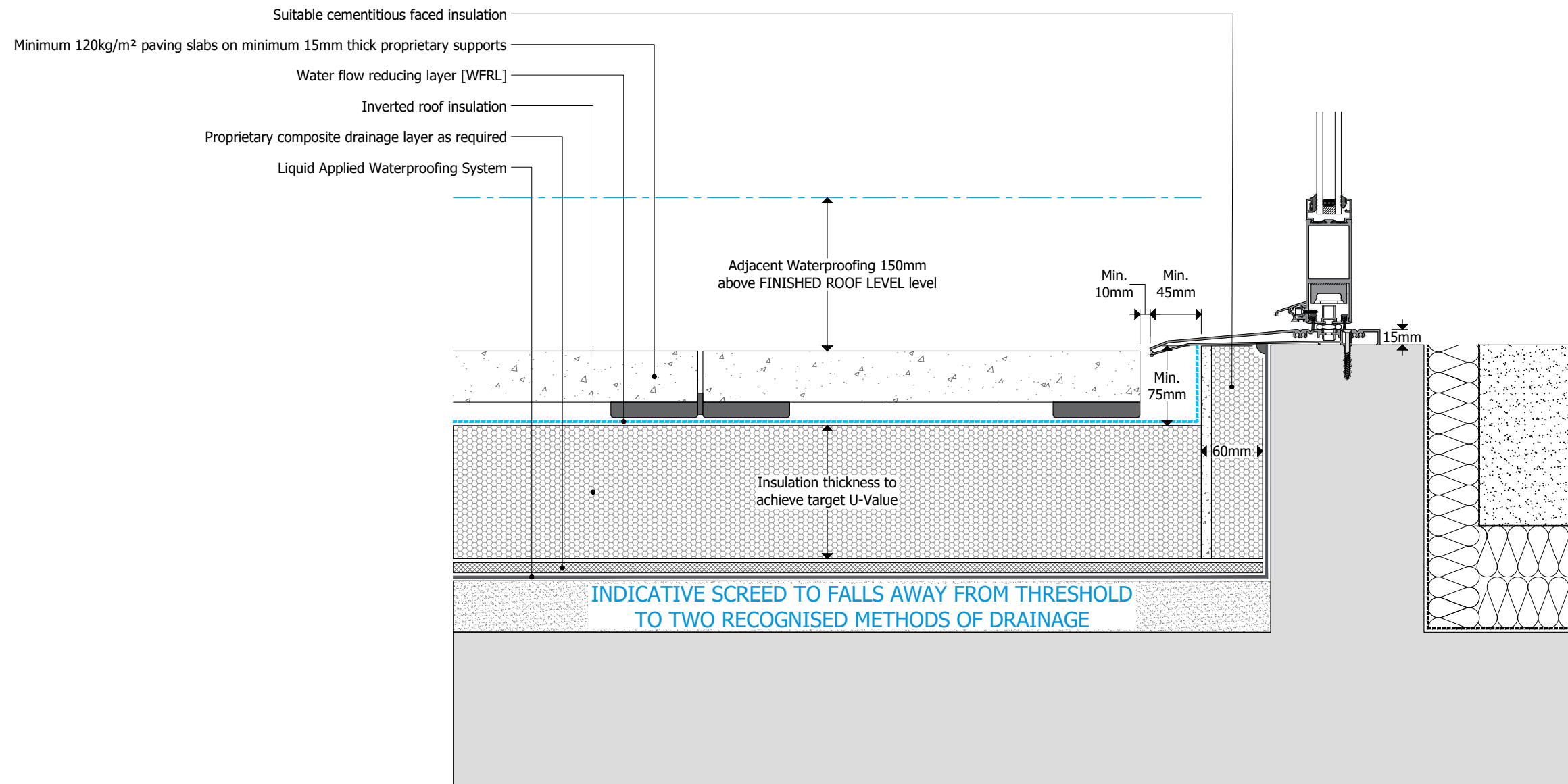

INHABITED SPACE BENEATH TERRACE/BALCONY

Drawing Status: FOR INFORMATION	
DWG N ^o 010	Revision
Drawing Title: Typical Inverted Balcony Installation To a Low Level Threshold	
Scale: NTS @ A3	Drawn: LRWA
Date: August 2020	
<small>This drawing is the confidential property of the Liquid Roof Waterproofing Association. All rights in respect of patents, design and copyrights are reserved. Moreover it is solely intended to illustrate the current best practice installation of the secondary roof components only, and must be read in conjunction with appropriate system specification and current issue of relevant Product Data Sheets. Elements bearing reference to structural and/or thermal design are shown indicatively and should not be used for any aspect of project design without consulting the relevant authorities.</small>	

